

TexasArchitect

NOVEMBER/DECEMBER 2011



AIA Dallas Announces Design Awards

DALLAS A total of 13 projects were recently recognized with Design Awards by AIA Dallas. The chapter's annual awards program celebrates the work of local architects, as well as the efforts of clients and consultants toward achieving design excellence. Three levels of awards – Honor, Merit, and Citation – were presented by two separate juries, one for built projects and a separate panel for unbuilt work, during different events.

The jury chair for the built awards program was Steven Ehrlich, FAIA, of Ehrlich Architects in Culver City, Calif. His fellow jurors were Susan Piedmont-Palladino, an architect who also is an author, a professor at Virginia Tech's Washington-Alexandria Architecture Center, and a curator at the National Building Museum; and Craig Curtis, FAIA, a partner at the Miller Hull Partnership in Seattle.

From a field of just under 70 entries, the jury presented two Honor Awards, four Merit Awards, and three Citation Awards presented. In addition, the jury chose one project to receive the chapter's Blackson Brick Community Design Award.

The two Honor Awards were presented to:

Glenwood Residence by Wernerfield, which responds to the client's desire for both privacy

and strong connections to the outdoors. Organized around a central courtyard, the project pushed the house towards the rear of the site to respect the scale of the surrounding streetscape. Stone walls screen the interior space and act as wayfinding devices to the entry sequence. Large overhangs create outdoor spaces and block the south sun. Other sustainable features include geothermal heating and cooling, along with a high-performance building envelope.

Sabine Hall Science Building by Perkins + Will, which serves as a campus "living room" for Dallas County Community College's Richland College. The building provides undergraduate life sciences teaching labs, faculty offices, tutoring labs, bookstore, and coffee shop. A modern response to the established architectural style of the campus, the building respects the surroundings but celebrates its uniqueness. A showcase for science, the project earned LEED Platinum certification.

The four Merit Awards went to:

Emerging Dallas by NIMMO American Studio for Progressive Architecture, which responds to an ideal of social conscience rather than physical context. The project – four similarly sized residences – offers affordable housing while also addressing issues of sustainability by taking only one-fourth the amount of

land used by a typical single-family dwelling. The resulting density creates a shared outdoor public realm.

Corporate Headquarters at Old Parkland by Good Fulton & Farrell Architects, which rejuvenated the 1920s-era Old Parkland Hospital's campus. The architects carefully restored existing buildings and integrated a new modern structure. The respect shown by the architects for the historic fabric is evident in the manner in which they tucked new parking under the site to maintain its stately character and beautiful lawns.

Library in the Park by Oglesby Greene, which nestles a community-based branch library within a neighborhood of single-family residences. The architects' respect for an existing grove of trees and other site constraints, along with the orientation of support spaces to the street, allowed the primary public spaces to take advantage of the park views. Transparency and natural materials further the building's connection its natural surroundings.

Chapel Hill Residence by Welch Architecture, which combines sustainable design strategies and an artisan's attention to detail. The single-family home's classic modern design features an open plan, expressed structure, and honest use of materials that embrace technol-



Glenwood Residence



Sabine Hall Science Building

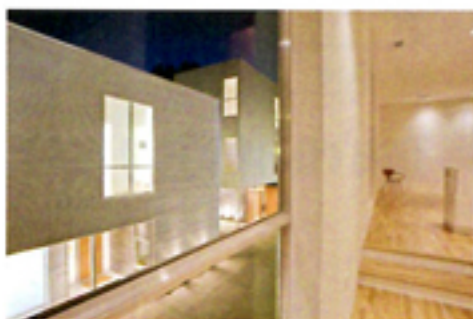

Emerging Dallas



Corporate Headquarters at Old Parkland



Library in the Park



Chapel Hill Residence